



Regular Meeting
7:00 p.m., Monday, May 2, 2022
Farmington City Hall
23600 Liberty Street
Farmington, MI 48335

REGULAR MEETING AGENDA

1. **Roll Call**
2. **Approval of Agenda**
3. **Public Comment**
4. **Presentation: Commission on Aging**
5. **Appointment to Commission on Aging**
6. **Presentation: DDA Budget**
7. **Consideration to adopt resolution to approve temporary relocation of precincts 3, 4, and 5 for the August 2, 2022 election**
8. **Consideration to approve the DTE Work Order to remove 10 cobra head streetlights and install the required street light controller in preparation for the Farmington Road Streetscape**
9. **Consideration to accept bid for 2022 Road Rehabilitation Program**
10. **Consideration to approve a Temporary Easement for Yoder Drive**
11. **Appointments to the Commission for Children Youth and Families**
12. **Appointment to Historical Commission**

- 13. Closed session: Strategy and negotiation connected with the negotiation of a collective bargaining agreement**
- 14. Other Business**
- 15. Public Comment**
- 16. Council Comment**
- 17. Adjournment**

The City will follow its normal procedures for accommodation of persons with disabilities. Those individuals needing accommodations for effective participation in this meeting should contact the City Clerk (248) 474-5500, ext. 2218 at least two working days in advance of the meeting. An attempt will be made to make reasonable accommodations.

Farmington City Council Staff Report	Council Meeting Date: May 2, 2022	Item Number 5
Submitted by: Assistant to the City Manager Melissa Andrade		
Agenda Topic: Board and Commission Appointment		
Proposed Motion: Move to appoint Mic Fahey as an alternate to the Commission on Aging for a term ending June 30, 2025.		
Background: City Council interviewed Mic Fahey at its April 18, 2022 Special Council Meeting.		
Materials:		

**Farmington City Council
Staff Report**

**Council Meeting
Date: May 2, 2022**

**Item
Number**

6

Submitted by: Kate Knight, DDA Director

Agenda Topic:

Presentation of DDA Budget FY2022-23

Proposed Motion:

N/A
For discussion

Background:

Please find for your review the proposed budget for the fiscal year beginning July 1, 2022 and ending June 30, 2023.

Please note the following highlights:

- Property tax revenue are projected to increase 5%, an encouraging indicator as we emerge from a global pandemic.
- Debt service commitment increases by \$91,000, as the DDA's portion of the Farmington Road Streetscape activates. This effectively doubles the DDA's commitment to capital project debt service at \$200,000.
- Metromode continuation of communications, \$24,000
- Repairs and Maintenance budget within PSD, from \$97,000 (increase of 5%), to reflect first year of approved five year PSD cycle.
- Decrease in Capital Outlay budget from \$117,767 to \$58,362, to reflect the ending of streetscape design/engineering and project costs for the Farmington Road Streetscape as the project is executed.

Materials: None

FUND 248 - DOWNTOWN DEVELOPMENT AUTHORITY FUND

DESCRIPTION	2019-20 Actual	2020-21 Actual	2021-22 Amended Budget	2021-22 Projected Activity	2022-23 Manager Proposed
DOWNTOWN DEVELOPMENT AUTHORITY REVENUES					
Dept 000.00-TIF					
PROPERTY TAXES, OPR, REV	(22,553)	4,873	(5,000)	(5,000)	0
PROPERTY TAXES, TWO MILL LEVY	44,580	0	0	0	0
PROPERTY TAXES, TIFA	341,395	447,670	439,000	439,000	462,000
FEDERAL GRANTS (CAP)	0	1,030	0	0	0
GRANTS, OTHER	4,180	11,792	1,000	3,000	1,000
INVESTMENT INCOME	7,579	2,340	500	671	800
REVENUES, OTHER	0	0	0	1,500	0
Total	375,181	467,705	435,500	440,706	465,335
Dept 759.00-PRINCIPAL SHOPPING DISTRICT					
PROPERTY TAXES, TWO MILL LEVY	0	45,547	45,571	45,571	47,289
FEDERAL GRANTS	0	29,912	0	0	0
REVENUES, OTHER	30,714	99,822	6,500	24,826	26,630
DDA DISTRICT, SP ASSESSMENT	184,000	186,000	188,000	188,000	200,140
Total	214,714	361,281	240,071	258,397	274,059
Dept 761.00-FOUNDERS FESTIVAL					
REVENUES, OTHER	0	10,000	0	10,000	10,000
Total	0	10,000	0	10,000	10,000
Dept 762.00-ART ON THE GRAND					
VENDOR FEES	0	450	2,500	1,350	1,350
SPONSORSHIPS	0	4,950	5,500	5,500	5,500
REVENUES, OTHER	0	3,631	3,400	3,600	3,600
Total	0	9,031	11,400	10,450	10,450

FUND 248 - DOWNTOWN DEVELOPMENT AUTHORITY FUND

DESCRIPTION	2019-20 Actual	2020-21 Actual	2021-22 Amended Budget	2021-22 Projected Activity	2022-23 Manager Proposed
Dept 764.00-HARVEST MOON CELEBRATION					
CONCESSION, HARVEST MOON	32,849	0	19,500	38,690	20,000
ADMISSIONS, HARVEST MOON	18,817	10	9,750	30,650	15,000
SPONSORSHIPS	5,600	1,500	4,000	6,900	4,000
REVENUES, OTHER	500	0	1,000	1,811	1,350
Total	57,766	1,510	34,250	78,051	40,350
Dept 766.00-RHYTHMZ IN RILEY PARK					
SPONSORSHIPS	3,900	700	18,000	15,750	21,850
Total	3,900	700	18,000	15,750	21,850
Dept 767.00-BUILDING RENTAL					
RENTAL FEES	40,615	40,135	41,940	27,731	41,940
REVENUES, OTHER	188	287	0	0	0
Total	40,803	40,422	41,940	27,731	41,940
Dept 768.00-LUNCH BEATS					
SPONSORSHIPS	1,450	2,000	3,000	300	4,100
REVENUES, OTHER	0	0	1,200	0	0
Total	1,450	2,000	4,200	300	4,100
Dept 769.00 - GRAND RAVEN FESTIVAL					
SPONSORSHIPS	0	10,000	13,000	12,400	13,500
REVENUES, OTHER	0	3,704	1,200	550	600
Total	0	13,704	14,200	12,950	14,100
Dept 770.00 - COMMUNITY FOUNDATION					
GRANTS, OTHER	0	0	0	3,000	0
CONTRIBUTIONS HARVEST MOON	0	0	0	7,000	0
Total	0	0	0	10,000	0
TOTAL DOWNTOWN DEVELOPMENT AUTHORITY REVENUES	693,814	906,353	799,561	864,335	882,184

FUND 248 - DOWNTOWN DEVELOPMENT AUTHORITY FUND

DESCRIPTION	2019-20 Actual	2020-21 Actual	2021-22 Amended Budget	2021-22 Projected Activity	2022-23 Manager Proposed
DOWNTOWN DEVELOPMENT AUTHORITY EXPENDITURES					
Dept 000.00-TIF					
SALARIES, FULL TIME	71,391	74,970	80,112	80,112	82,515
SALARIES, DC RETIREE HEALTH CARE	2,100	2,100	2,100	2,100	2,100
SALARIES, PART-TIME/TEMP	19,935	21,331	23,000	30,000	30,668
SALARIES, OVERTIME	677	0	0	0	0
SALARIES, ACCRUED BENEFITS	(31)	(1,024)	596	596	613
LONGEVITY PAY	0	0	65	260	325
PYMT IN LIEU OF HOSP INS	2,400	2,400	2,400	2,400	2,400
FICA, EMPLOYER'S SHARE	7,251	7,585	6,569	8,879	9,120
COMPREHENSIVE MEDICAL INSURANCE	1,183	1,084	1,309	1,309	1,362
LIFE INSURANCE	118	138	155	187	192
LONG TERM DISABILITY	98	113	117	171	176
WORKMEN'S COMPENSATION INS	307	299	318	402	414
CONTRIBUTION, PENSION	12,827	15,812	19,475	19,475	20,721
OFFICE SUPPLIES	249	1,149	800	200	800
POSTAGE, METER	102	372	200	200	200
NON-CAPITALIZED ASSETS	0	0	0	0	0
PROFESSIONAL SERVICES	36,379	47,411	26,850	121,800	16,850
SEASONAL DECORATIONS, GARDENING	22,913	0	0	0	0
CONTRACTUAL SERVICES	15,500	20,141	35,000	25,000	25,000
TELECOMMUNICATIONS	1,141	1,154	1,150	1,750	1,750
TRANSPORTATION	498	69	500	500	500
RENTALS	2,270	3,570	1,560	0	0
MISCELLANEOUS EXPENSE	580	367	2,000	2,000	2,000
MEMBERSHIPS, SUBSCRIPTIONS	740	997	800	825	825
PROFESSIONAL DEV, CONFERENCES	1,587	(138)	6,900	7,480	7,480
CAPITAL OUTLAY	127,186	33,507	117,767	35,000	58,362
DEBT SERVICE	99,934	96,184	105,757	111,461	200,962
Total	427,335	329,591	435,500	452,107	465,335

FUND 248 - DOWNTOWN DEVELOPMENT AUTHORITY FUND

DESCRIPTION	2019-20 Actual	2020-21 Actual	2021-22 Amended Budget	2021-22 Projected Activity	2022-23 Manager Proposed
Dept 759.00-PRINCIPAL SHOPPING DISTRICT					
SALARIES, PART-TIME/TEMP	2,018	1,067	6,720	5,850	7,830
FICA, EMPLOYER'S SHARE	154	82	514	514	514
SEASONAL DECORATIONS,GARDENING	0	98,087	25,000	37,152	40,600
CONTRACTUAL SERVICES	42,128	45,471	44,268	44,268	45,600
COMMUNITY PROMOTION	48,806	66,079	40,000	44,392	46,916
BUSINESS DEVELOPMENT	5,000	0	4,000	5,000	4,000
COMMUNICATIONS	0	0	0	0	0
VOLUNTEER MANAGEMENT	1,439	1,790	4,000	5,500	4,000
PUBLIC UTILITIES	22,519	23,976	22,500	20,000	27,500
REPAIRS & MAINTENANCE	119,725	114,597	93,069	97,649	97,099
Total	241,789	351,149	240,071	260,325	274,059
Dept 761.00-FOUNDERS FESTIVAL					
CONTRACTUAL SERVICES	0	10,000	0	10,000	10,000
Total	0	10,000	0	10,000	10,000
Dept 762.00-ART ON THE GRAND					
COMMUNITY PROMOTION	46	3,360	9,400	4,050	4,050
ENTERTAINMENT	0	700	500	3,500	3,500
EQUIPMENT RENTAL	0	2,557	1,500	2,900	2,900
Total	46	6,617	11,400	10,450	10,450
Dept 764.00-HARVEST MOON CELEBRATION					
OFFICE SUPPLIES	0	0	500	0	0
CONCESSION SUPPLIES	16,654	0	12,300	18,344	9,172
CONTRACTUAL SERVICES	0	0	0	2,700	2,800
COMMUNITY PROMOTION	4,734	26	3,985	2,687	3,400
ENTERTAINMENT	4,800	0	4,800	8,950	9,000
EQUIPMENT RENTAL	7,191	0	8,015	7,375	8,600
MISCELLANEOUS EXPENSE	6,927	(300)	4,650	5,335	7,378
CONTRIBUTION, COMMUNITY FOUNDATION	0	0	0	7,000	0
Total	40,306	(274)	34,250	52,391	40,350

FUND 248 - DOWNTOWN DEVELOPMENT AUTHORITY FUND

DESCRIPTION	2019-20 Actual	2020-21 Actual	2021-22 Amended Budget	2021-22 Projected Activity	2022-23 Manager Proposed
Dept 766.00-RHYTHMZ IN RILEY PARK					
CONTRACTUAL SERVICES	9,335	2,880	7,200	2,220	10,500
COMMUNITY PROMOTION	525	636	2,800	1,919	2,250
ENTERTAINMENT	5,525	0	8,000	5,325	9,100
Total	15,385	3,516	18,000	9,464	21,850
Dept 767.00-BUILDING RENTAL					
PROFESSIONAL SERVICES	4,557	4,734	5,100	5,100	5,202
CONTRACTUAL SERVICES	11,023	11,155	16,381	15,833	16,590
PUBLIC UTILITIES	281	126	0	500	525
MAINT, BUILDING & GROUNDS	8,686	3,271	6,000	4,000	6,292
CONTRIBUTION INS & BONDS	253	542	558	550	573
CAPITAL OUTLAY, BUILDINGS	15,178	0	5,000	8,880	5,000
Total	39,978	19,828	33,039	34,863	34,182
Dept 768.00-LUNCH BEATS					
CONTRACTUAL SERVICES	1,000	250	1,000	250	1,200
COMMUNITY PROMOTION	225	363	2,075	1,546	1,380
ENTERTAINMENT	850	0	1,125	675	1,520
Total	2,075	613	4,200	2,471	4,100
Dept 769.00 - GRAND RAVEN FESTIVAL					
COMMUNITY PROMOTION	0	1,842	1,800	1,812	1,875
EVENTS	0	6,110	6,660	12,654	4,375
MISCELLANEOUS EXPENSE	0	4,634	5,740	10,379	7,850
Total	0	12,586	14,200	24,845	14,100
Dept 770.00 - COMMUNITY FOUNDATION					
CONTRIBUTION, COMMUNITY FOUNDATION	0	0	0	10,000	0
Total	0	0	0	10,000	0
TOTAL DOWNTOWN DEVELOPMENT AUTHORITY EXPENDITURES	766,914	733,626	790,660	866,916	874,426

FUND 248 - DOWNTOWN DEVELOPMENT AUTHORITY FUND

DESCRIPTION	2019-20 Actual	2020-21 Actual	2021-22 Amended Budget	2021-22 Projected Activity	2022-23 Manager Proposed
Surplus/(Deficit)	(73,100)	172,727	8,901	(2,581)	7,758
BEGINNING FUND BALANCE	204,251	131,151	303,878	303,878	301,297
ENDING FUND BALANCE	131,151	303,878	312,779	301,297	309,055

**Farmington City Council
Staff Report**

**Council Meeting
Date: May 2, 2022**

**Item
Number**

7

Submitted by: Mary Mullison, City Clerk

Agenda Topic: Consideration to Adopt Resolution to Approve Temporary Relocation of Precincts 3, 4, and 5 for the August 2, 2022 election

Proposed Motion: Move to adopt a resolution to temporarily relocate Election Precincts 3 and 4 from Farmington High School to the Maxfield Education Center and Precinct 5 from Longacre Elementary School to the FPS Administration Building for the August 2, 2022 election.

Background:

In early March Sandra Rivett, Farmington Public Schools Facilities Scheduler and Coordinator, let us know that both Farmington High School and Longacre Elementary School would be unavailable to use as polling places in August because of extensive summer construction projects. This will impact three of the City's five precincts.

The City Clerk requests that for the August 2, 2022 election, the City temporarily relocate Precincts 3 and 4 to the Maxfield Education Center and Precinct 5 to the former School Board meeting room in the FPS Administration Building. Ms. Rivett was instrumental in finding rooms that were ADA compliant and within election law, and she was very invested in helping us find temporary polling places within Farmington Public School buildings.

As a result of these moves we will need to inform all voters assigned to the three affected precincts of the temporary relocation and will provide additional signage and in-person help on election day.

Materials:

Proposed Water Bill Insert

CITY OF FARMINGTON

OAKLAND COUNTY, MICHIGAN

RESOLUTION NO.

**RESOLUTION APPROVING TEMPORARY RELOCATION OF
ELECTION PRECINCTS 3, 4, & 5**

At a meeting of the City Council of the City of Farmington, Oakland County, Michigan, held on the 2nd day of May, 2022, at the City Hall, 23600 Liberty Street, Farmington, Michigan 48335.

PRESENT:

ABSENT:

The following resolution was offered by Councilmember _____, and seconded by Councilmember _____ :

WHEREAS, Farmington Public Schools advised the City on March 3, 2022 that both Longacre Elementary School and Farmington High School will be unavailable for polling places for the August 2, 2022 Primary Election due to summer construction projects; and

WHEREAS, the City Clerk and the FPS Facilities Scheduler and Coordinator worked together to determine alternative sites within other administrative buildings owned by Farmington Public Schools that meet ADA requirements and provide adequate space for all three precincts; and

WHEREAS, pursuant to Act No. 116, Section 662 (1) of the Public Acts of Michigan, of 1954, the city legislative body shall designate and prescribe the place or places of holding an election within the city.

NOW, THEREFORE, IT IS HEREBY RESOLVED that the Farmington City Council approves temporarily moving Election Precincts No. 3 and 4 to the Maxfield Education Center located at 32789 W 10 Mile Rd, Farmington, MI 48336, and Election Precinct No. 5 to the Administrative Building located at 32500 Shiawassee Rd, Farmington, MI 48336, for the August 2, 2022 Primary Election.

ROLL CALL

Ayes:

Nays:

Absent:

MOTION CARRIED UNANIMOUSLY.

I, Mary Mullison, the duly-qualified Clerk of the City of Farmington, Oakland County, Michigan, do hereby certify that the foregoing is a true and complete copy of a Resolution adopted by the City Council of the City of Farmington at a duly-called meeting held on May 2, 2022, a copy of which is on file in my office.

MARY J. MULLISON
Clerk, City of Farmington

IMPORTANT ELECTION NOTICE

August 2, 2022 Primary Election Only



Due to summer construction at Longacre and Farmington High Schools, voters in Precincts 3, 4, and 5 have a Polling Location Change.

The Temporary Polling Locations are as follows:

Precinct 3: Maxfield Education Center, Door 4
Large Meeting Room
32789 W 10 Mile Rd
Farmington, MI 48336

Precinct 4: Maxfield Education Center, Door 4
Room 6
32789 W 10 Mile Rd
Farmington, MI 48336

Precinct 5: Farmington Board of Education, Door 2
Large Meeting Room
32500 Shiawassee Rd
Farmington, MI 48336



Maps have been provided on the back of this notice. To view election information, visit www.farmgov.com/elections.

Please direct questions to farmingtonclerk@farmgov.com or 248-474-5500 ext 2228.

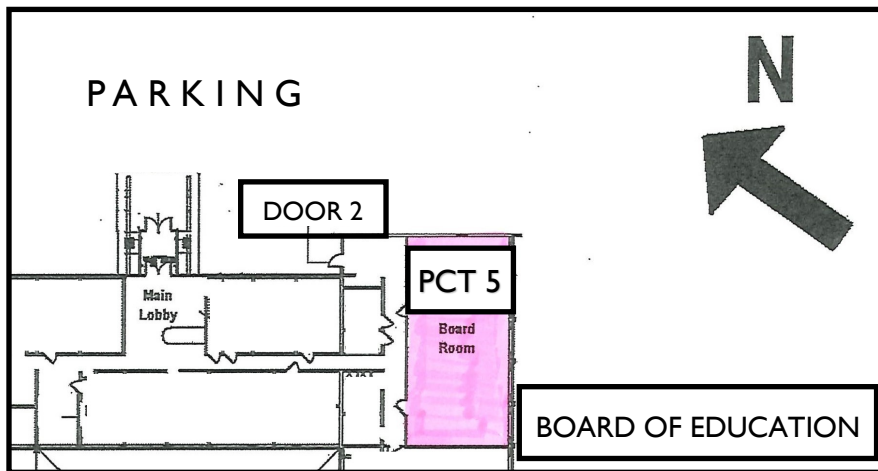
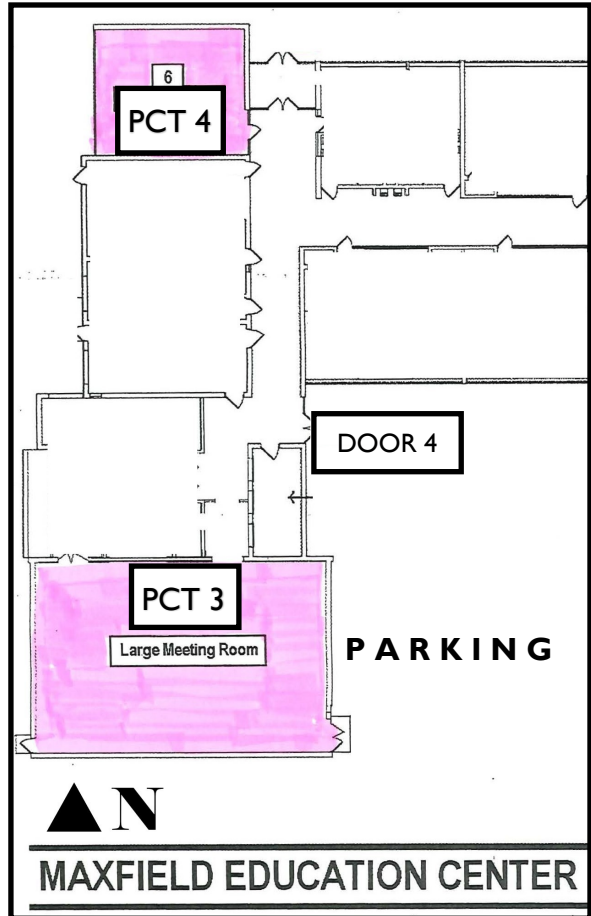
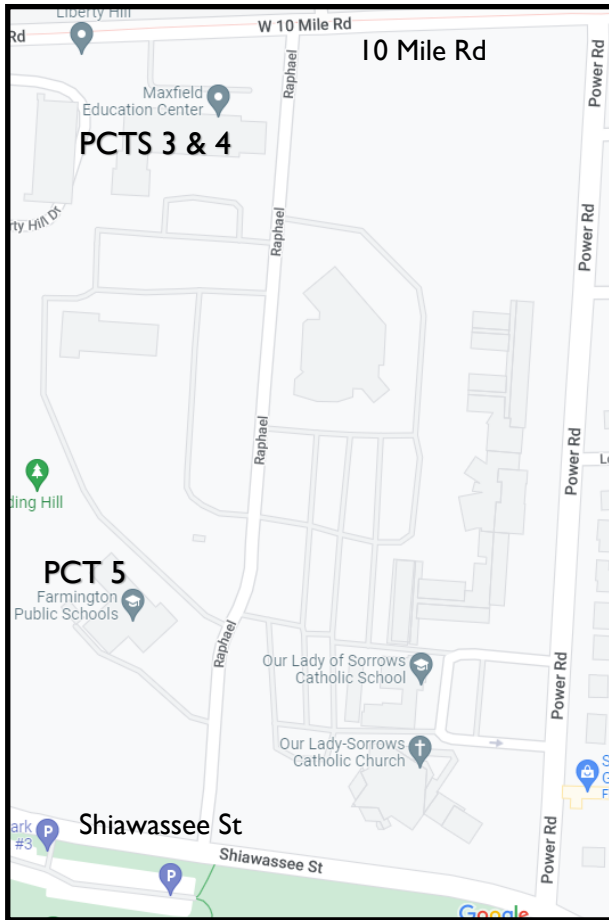

Still uncertain about where you vote? Snap a picture of the QR code on the right, or visit bit.ly/FarmingtonVotes for our interactive map!



Farmington City Council Staff Report	Council Meeting Date: May 2, 2022	Item Number 8
Submitted by: Charles Eudy, Superintendent		
Agenda Topic: DTE Lamp removals on Farmington Road		
Proposed Motion: Move to approve the DTE work order and contingency funds in the amount of \$30,270 to remove 10 cobra head streetlights and foundations, abandon the underground cable, and install the required streetlight controller in preparation for the Farmington Road Streetscape; and allow City Administration to execute the contract subject to any minor amendments to the final form of the City Manager's office and the City Attorney's office.		
<p>Background:</p> <p>The approved Farmington Road Streetscape project will require the removal of the 10 DTE Cobra Head streetlights, foundations, abandonment of the underground cables, and install the LC73 streetlight controller. The cobra head fixtures removed from Farmington Road between Grand River & Alta Loma will be replaced with decorative DDA lamppost. DTE has provided a quote in the amount of \$27,517.43 to conduct the removals & abandonment. Within DTE's proposal "<i>When direct construction cost exceed those estimated due to unforeseen difficulties, the Customer will be invoiced for the difference</i>". For that reason, City Administration is recommending approximately 10% contingency funds (\$2,752.57) to be included, totaling \$30,270.</p> <p>City Administration has requested DTE to provide information of cost savings if they were not required to remove the pole foundations. DTE advised their cost reduction would be approximately \$10,000. The streetscape contractor would be required to provide a quote to remove the foundations as an extra. Engineers at OHM recommend having DTE remove their infrastructure foundations.</p> <p>Funding for the streetlight removals would be drawn from the Contingency Funds allocated for this project.</p>		
<p>Materials: DTE Work Order # 64984083 DTE Page #1 Removals & Abandonment</p>		



April 14, 2022

Removal/Relocation of Equipment Billing Agreement

I/We, the undersigned, hereby agree to reimburse DTE Energy the sum of **\$27,517.43**. This reimbursement will be made prior to the actual start of construction.

In return for the above, DTE Energy agrees to remove 10 UG fed streetlights and concrete foundations and abandon UG streetlight cable on Farmington Rd. between Grand River & Alta Loma. Trench in 2" conduit & UG cable on the south side of Grand River west of Oakland St. to refeed remaining streetlights. Install LC73 streetlight controller on existing wood pole. We, the undersigned, also agree that the specific object of the above requested work is to remove 10 streetlight posts as shown on **Work Order #64984083 (Exhibit "B")**. When direct construction costs exceed those estimated due to unforeseen difficulties, the Customer will be invoiced for the difference.

Notwithstanding anything herein to the contrary, the installation, ownership and maintenance of electric services and the rates, fees and charges to be made shall be subject to and in accordance with the orders, rules and regulations adopted and approved by the Michigan Public Service Commission.

Please sign and return **BOTH** copies of this agreement along with payment. You will be mailed back 1 original of this agreement after document is counter-signed by DTE supervision.

Accepted (Customer)

Accepted (DTE)

By _____

By _____

Name _____

Name _____

Date _____

Date _____

RM SL CABLE TAP IN POST (13)



Know what's below.
Call before you dig

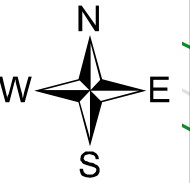

PAGE #1 OF 2

ABANDON UG SL CABLE

RM POST CODE 005
RM FOUNDATION DISPOSED
RM UG MULTIPLE LED 136 LGC COBRA

RM POST CODE 005
RM FOUNDATION DISPOSED
RM UG MULTIPLE LED 136 LGC COBRA

ABANDON UG SL CABLE

RM POST CODE 005
RM FOUNDATION DISPOSED
RM UG MULTIPLE LED 136 LGC COBRA

RM DET 23223A
RM PCLL

STATE ST RM POST CODE 004
RM FOUNDATION DISPOSED
RM UG MULTIPLE LED 136 LGC COBRA

RM POST CODE 004
RM FOUNDATION DISPOSED
RM UG MULTIPLE LED 136 LGC COBRA

RM POST CODE 004
RM FOUNDATION DISPOSED
RM UG MULTIPLE LED 136 LGC COBRA

ABANDON UG SL CABLE

RM POST CODE 004
RM FOUNDATION DISPOSED
RM UG MULTIPLE LED 136 LGC COBRA

ABANDON UG SL CABLE

ABANDON UG SL CABLE

RM POST CODE 004
RM FOUNDATION DISPOSED
RM UG MULTIPLE LED 136 LGC COBRA

RM POST CODE 004
RM FOUNDATION DISPOSED
RM UG MULTIPLE LED 136 LGC COBRA

ABANDON UG SL CABLE

ABANDON UG SL CABLE

RM POST CODE 06
RM FOUNDATION DISPOSED
RM UG MULTIPLE LED 136 LGC COBRA

ORCHARD ST

RM SL CABLE TAP IN POST (1)

ALTA LOMA ST

ABANDON UG SL CABLE

RM SL CABLE TAP IN POST (17)

Streetlight Billing Summary				
O120 - FARMINGTON CITY OF				
7031	FRMTN	RM	2	*705
7033	FRMTN	RM	2	*705
9000	FRMTN	RM	2	*703
9000	FRMTN	RM	4	*705

*** JOB NOTES PAGE #1 ***

**RM 10 UG FED STREETLIGHT POSTS
RM 10 CONCRETE FOUNDATIONS
ABANDON UG STREETLIGHT CABLE**

*** JOB NOTES PAGE #2 ***

**TRENCH 60' & INSTALL 2" CONDUIT
INSTALL 85' UG CABLE #2ALX2-#4ALX1
IN 984 RISER & LC73 SL CONTROLLER
TO RE-FEED EXISTING STREETLIGHTS**

DTE DTE Electric - Distribution Engineering and Planning

Service Planner	Wincel, Thomas J					Work Order Description	SL-Removal for Streetscape on Farmington Rd bet Grand River & Freedom							
Work Order #	64984083	GIS-DSN	COH	CUL	CUG	PLC								
Phone	586.783.1968	Circuit #1	DRAKE9117		Circuit #2	PH	SCMAT							
Supervisor	Brian R Kinnick	Service Center	WWS	Worksites City	FARMINGTON	Worksites Twp	FAR	County	Oakland					
Phone	734.397.4024	JU Work to be Performed			JU	RSD								
Planning Engineer	JU Company		Contact	Email		Phone								
Phone	JU Company		Contact	Email		Phone								
CUE Number	1265768	Ver	1	Plot Date	4/14/2022	Scale	Town	01N	Range	09E	Section	27	Qtr	

**Farmington City Council
Staff Report**

Council Meeting Date:
May 2, 2022

**Item
Number
9**

Submitted by: Charles Eudy, Superintendent

Agenda Topic:

Consideration to accept bid for 2022 Road Rehabilitation Program

Proposed Motion:

Move to accept bids and award the 2022 Road Rehabilitation Program to Best Asphalt, Inc. in the amount of \$999,000.00, and allow City Administration to execute the contract documents.

Background:

In conjunction with the city's consulting engineers Orchard Hiltz & McCliment Advisors (OHM), bids were solicited for the 2022 Road Rehabilitation Program. The committee selected multiple local streets based upon PASER Score, infrastructure condition including water main, and sanitary sewer. The 2022 Road Rehabilitation Program will not conflict with other capital improvement projects this year.

Bids were opened on Wednesday April 13, 2022. A total of four (4) bids was received which are listed below. OHM and City Administration have reviewed the bid tabulations along with contractor work history and references. OHM recommends awarding the contract for the 2022 Road Rehabilitation Program in the amount of \$953,316.54 to Best Asphalt Incorporated located at 6334 N. Beverly Plaza, Romulus MI. 48174. Engineers at OHM recommend including a contingency of approximately 5% to cover unforeseen issues. The total construction contract not to exceed \$999,000.00 should be approved by Council.

Bid Tabulation

Best Asphalt Inc.	\$ 953,316.54
Cadillac Asphalt	\$1,058,678.94
Asphalt Specialists Inc.	\$1,122,874.50
Pro-line Asphalt Paving Inc.	\$1,227,032.00

Engineers at OHM provided City Administration with the Engineers Opinion of Construction Cost in late 2021. City Administration budgeted the lower range of the engineers estimate in February 2022. The 2022 Road Rehabilitation Program Project bids are at the upper range of the engineers' estimate. Completion of this project as designed will require a larger transfer from major streets to local streets than anticipated to cover the elevated contractual services.

Materials:

OHM Recommendation of award
Bid Tab

April 15, 2022

Mr. Chuck Eudy
Public Works Superintendent
City of Farmington
23600 Liberty Street
Farmington, MI 48335

Regarding: Recommendation of Award – 2022 Road Rehabilitation Program

Sealed bids for the above-mentioned project were received and publicly read aloud by OHM Advisors on Wednesday, April 13, 2022, at 11:00 a.m. Proposals were received from four (4) bidders. The list of bidders and their total bid amounts are included in the table below. We have calculated the bid amounts of all work items from the bidders in the attached bid tabulation. The Engineer's Opinion of Construction Cost for this project was estimated to be approximately \$995,360.

Contractor Name	Bid Amount
Best Asphalt, Inc.	\$953,316.54
Cadillac Asphalt	\$1,058,678.94
Asphalt Specialists, Inc.	\$1,122,874.50
Pro-line Asphalt Paving Co.	\$1,227,032.00

The project scope consists of approximately 1.5 miles of HMA road rehabilitation and associated stormwater drainage and ADA sidewalk improvements. The work to be completed under this Contract includes the furnishing of all materials, equipment, and labor necessary to complete the proposed work, in accordance with the contract documents.

Best Asphalt, Inc., located at 6334 Beverly Plaza in Romulus, MI, is the low bidder. OHM Advisors has had favorable past-experience working with this Contractor on previous projects. We spoke with Best Asphalt, Inc. directly regarding the scope of work and anticipated project schedule, and they indicated that they are comfortable with completing all work items within the time allotted to substantial complete the project.

In addition to the above, Best Asphalt, Inc. also fulfilled the Qualifications-Based Selection (QBS) criteria specified in the bidding requirements for this project.

Based on the above evaluation, we recommend award of the 2022 Road Rehabilitation Program project to Best Asphalt, Inc. in the not to exceed amount of \$999,000.00, which includes an approximate contingency budget just under 5% to help cover unforeseen issues.

We look forward to continuing to provide our professional services on this project through the construction phase of work. If you have any questions, please do not hesitate to reach out.



Sincerely,
OHM Advisors

Matthew D. Parks, P.E.

Austin Downie

Enclosure: Bid Tab

cc: David Murphy, City Manager
File

P:\0101_0125\0111210050_2022_Road_Rehab_Program\PM\Correspondence\0111-21-0050_Recommendation of Award.docx

Tabulation of Bids Received on 4/13/2022
2022 Road Rehabilitation Program
 City of Farmington, Oakland County, MI
 OHM Job No.: 0111-21-0050

Best Asphalt, Inc.
 6334 N Beverly Plaza
 Romulus, MI 48174

Cadillac Asphalt
 13501 S Huron River Dr
 Romulus, MI 48174

Asphalt Specialists, Inc.
 1780 E Highwood
 Pontiac, MI 48340

Pro-Line Asphalt Paving Co.
 11797 29 Mile Rd
 Washington, MI 48095

Phone: (734) 729-9440

Phone: (734) 941-0200

Phone: (248) 334-4570

Phone: (586) 752-7730

Item No.	Description	Estimated Quantity	Best Asphalt, Inc.		Cadillac Asphalt		Asphalt Specialists, Inc.		Pro-Line Asphalt Paving Co.	
			Unit Price	Amount	Unit Price	Amount	Unit Price	Amount	Unit Price	Amount
CATEGORY 1 - Misc.										
1)	Permit Fees Allowance	3000 Dir	\$1.00	\$3,000.00	\$1.00	\$3,000.00	\$1.00	\$3,000.00	\$1.00	\$3,000.00
2)	Exploratory Investigation, Vertical	20 Ft	\$150.00	\$3,000.00	\$545.00	\$10,900.00	\$75.00	\$1,500.00	\$545.00	\$10,900.00
3)	Subgrade Undercutting, Type II (Modified)	202 Cyd	\$75.00	\$15,150.00	\$66.00	\$13,332.00	\$60.00	\$12,120.00	\$66.00	\$13,332.00
4)	Subgrade Undercutting, Type II (Special)	202 Cyd	\$85.00	\$17,170.00	\$64.00	\$12,928.00	\$65.00	\$13,130.00	\$64.00	\$12,928.00
5)	Maintenance Aggregate, 21AA	130 Ton	\$50.00	\$6,500.00	\$40.00	\$5,200.00	\$27.15	\$3,529.50	\$40.00	\$5,200.00
6)	Hand Patching	8 Ton	\$250.00	\$2,000.00	\$500.00	\$4,000.00	\$350.00	\$2,800.00	\$500.00	\$4,000.00
7)	Sprinkler Line, up to 1 inch	150 Ft	\$4.00	\$600.00	\$7.00	\$1,050.00	\$9.00	\$1,350.00	\$5.00	\$750.00
8)	Sprinkler Head, Remove & Reset	15 Ea	\$85.00	\$1,275.00	\$80.00	\$1,200.00	\$101.00	\$1,515.00	\$100.00	\$1,500.00
9)	Sprinkler Head, Replace	15 Ea	\$90.00	\$1,350.00	\$80.00	\$1,200.00	\$101.00	\$1,515.00	\$100.00	\$1,500.00
TOTAL CATEGORY 1:				<u>\$50,045.00</u>	<u>\$52,810.00</u>	<u>\$40,459.50</u>	<u>\$53,110.00</u>			
CATEGORY 2 - Yoder Dr.										
10)	Audio Video Route Survey	1 LSUM	\$575.00	\$575.00	\$700.00	\$700.00	\$900.00	\$900.00	\$1,000.00	\$1,000.00
11)	Mobilization, Max 5%	1 LSUM	\$6,500.00	\$6,500.00	\$5,426.00	\$5,426.00	\$1,000.00	\$1,000.00	\$6,000.00	\$6,000.00
12)	Traffic Maintenance and Control	1 LSUM	\$650.00	\$650.00	\$3,674.00	\$3,674.00	\$1,500.00	\$1,500.00	\$10,000.00	\$10,000.00
13)	Curb, Rem	168 Ft	\$15.00	\$2,520.00	\$25.00	\$4,200.00	\$10.00	\$1,680.00	\$25.00	\$4,200.00
14)	Pavt, Rem	1537 Syd	\$25.00	\$38,425.00	\$5.00	\$7,685.00	\$5.00	\$7,685.00	\$5.00	\$7,685.00
15)	Sidewalk, Rem	31 Syd	\$25.00	\$775.00	\$15.00	\$465.00	\$22.00	\$682.00	\$15.00	\$465.00
16)	Sign, Rem	2 Ea	\$100.00	\$200.00	\$50.00	\$100.00	\$63.00	\$126.00	\$200.00	\$400.00
17)	Station Grading	4.09 Sta	\$2,775.00	\$11,349.75 ¹	\$3,625.00	\$14,826.25	\$5,000.00	\$20,450.00	\$5,500.00	\$22,495.00
18)	Erosion Control, Inlet Protection, Fabric Drop	4 Ea	\$105.00	\$420.00	\$245.00	\$980.00	\$250.00	\$1,000.00	\$250.00	\$1,000.00
19)	Aggregate Base, 21AA (Limestone), 6 inch	1535 Syd	\$12.00	\$18,420.00	\$11.00	\$16,885.00	\$10.00	\$15,350.00	\$11.00	\$16,885.00
20)	Utility Structure, Adj	2 Ea	\$750.00	\$1,500.00	\$2,000.00	\$4,000.00	\$400.00	\$800.00	\$2,000.00	\$4,000.00
21)	HMA, MDOT 13A	334 Ton	\$101.05	\$33,750.70	\$115.93	\$38,720.62	\$140.00	\$46,760.00	\$130.00	\$43,420.00
22)	Conc Pavt, Nonreinf, 8 inch	7 Syd	\$80.00	\$560.00	\$81.70	\$571.90	\$100.00	\$700.00	\$80.00	\$560.00
23)	Driveway Opening, Conc, Det M	30 Ft	\$50.00	\$1,500.00	\$55.00	\$1,650.00	\$63.00	\$1,890.00	\$50.00	\$1,500.00
24)	Curb, Conc, Det E2	160 Ft	\$45.00	\$7,200.00	\$55.00	\$8,800.00	\$56.00	\$8,960.00	\$45.00	\$7,200.00
25)	Sidewalk, Conc, 4 inch	137 Sft	\$8.00	\$1,096.00	\$6.50	\$890.50	\$10.00	\$1,370.00	\$8.00	\$1,096.00
26)	Sidewalk, Conc, 6 inch	137 Sft	\$10.00	\$1,370.00	\$8.50	\$1,164.50	\$13.00	\$1,781.00	\$10.00	\$1,370.00
27)	Post, Steel, 3 lb	28 Ft	\$15.00	\$420.00	\$15.00	\$420.00	\$18.00	\$504.00	\$25.00	\$700.00
28)	Sign, Type IIIB	6 Sft	\$50.00	\$300.00	\$50.00	\$300.00	\$63.00	\$378.00	\$50.00	\$300.00
29)	Pavt Mrkg, Waterborne, 4 inch, Blue	116 Ft	\$1.00	\$116.00	\$4.95	\$574.20	\$63.00	\$7,308.00	\$5.00	\$580.00
30)	Pavt Mrkg, Waterborne, 4 inch, Yellow	180 Ft	\$1.00	\$180.00	\$4.00	\$720.00	\$5.00	\$900.00	\$5.00	\$900.00
31)	Pavt Mrkg, Waterborne, Accessible Symbol Blue	2 Ea	\$35.00	\$70.00	\$60.00	\$120.00	\$75.00	\$150.00	\$500.00	\$1,000.00
32)	Turf Establishment	72 Syd	\$35.00	\$2,520.00	\$15.00	\$1,080.00	\$19.00	\$1,368.00	\$15.00	\$1,080.00

Tabulation of Bids Received on 4/13/2022
2022 Road Rehabilitation Program
 City of Farmington, Oakland County, MI
 OHM Job No.: 0111-21-0050

Best Asphalt, Inc.
 6334 N Beverly Plaza
 Romulus, MI 48174

Cadillac Asphalt
 13501 S Huron River Dr
 Romulus, MI 48174

Asphalt Specialists, Inc.
 1780 E Highwood
 Pontiac, MI 48340

Pro-Line Asphalt Paving Co.
 11797 29 Mile Rd
 Washington, MI 48095

Phone: (734) 729-9440

Phone: (734) 941-0200

Phone: (248) 334-4570

Phone: (586) 752-7730

Item No.	Description	Estimated Quantity	Unit Price	Amount	Unit Price	Amount	Unit Price	Amount	Unit Price	Amount					
TOTAL CATEGORY 2:				\$130,417.45 ²	TOTAL CATEGORY 2:				\$113,952.97	TOTAL CATEGORY 2:		\$123,242.00	TOTAL CATEGORY 2:		\$133,836.00
CATEGORY 3 - Glenview Dr.															
33)	Audio Video Route Survey	1	LSUM	\$1,800.00	\$1,800.00	\$1,025.00	\$1,025.00	\$900.00	\$900.00	\$1,000.00	\$1,000.00				
34)	Mobilization, Max 5%	1	LSUM	\$12,000.00	\$12,000.00	\$9,629.00	\$9,629.00	\$1,000.00	\$1,000.00	\$10,000.00	\$10,000.00				
35)	Traffic Maintenance and Control	1	LSUM	\$2,050.00	\$2,050.00	\$4,645.00	\$4,645.00	\$1,500.00	\$1,500.00	\$10,000.00	\$10,000.00				
36)	Pavt, Rem	97	Syd	\$25.00	\$2,425.00	\$22.00	\$2,134.00	\$18.00	\$1,746.00	\$22.00	\$2,134.00				
37)	Sidewalk, Rem	78	Syd	\$25.00	\$1,950.00	\$22.00	\$1,716.00	\$23.00	\$1,794.00	\$22.00	\$1,716.00				
38)	Sign, Rem	2	Ea	\$100.00	\$200.00	\$50.00	\$100.00	\$63.00	\$126.00	\$200.00	\$400.00				
39)	Erosion Control, Inlet Protection, Fabric Drop	15	Ea	\$105.00	\$1,575.00	\$245.00	\$3,675.00	\$267.00	\$4,005.00	\$250.00	\$3,750.00				
40)	Aggregate Base, 21AA (Limestone), 8 inch	1694	Syd	\$12.00	\$20,328.00	\$15.00	\$25,410.00	\$13.00	\$22,022.00	\$15.00	\$25,410.00				
41)	Utility Structure, Adj	2	Ea	\$750.00	\$1,500.00	\$2,000.00	\$4,000.00	\$630.00	\$1,260.00	\$2,000.00	\$4,000.00				
42)	Cold Milling HMA Surface	4804	Syd	\$2.31	\$11,097.24 ¹	\$4.34	\$20,849.36	\$3.00	\$14,412.00	\$5.00	\$24,020.00				
43)	HMA, MDOT 13A	1057	Ton	\$101.05	\$106,809.85	\$109.00	\$115,213.00	\$135.00	\$142,695.00	\$120.00	\$126,840.00				
44)	Conc Pavt with Integral Curb, Nonreinf, 8 inch	97	Syd	\$80.00	\$7,760.00	\$82.25	\$7,978.25	\$100.00	\$9,700.00	\$80.00	\$7,760.00				
45)	Detectable Warning Surface	20	Ft	\$60.00	\$1,200.00	\$40.00	\$800.00	\$75.00	\$1,500.00	\$60.00	\$1,200.00				
46)	Sidewalk, Conc, 4 inch	538	Sft	\$8.00	\$4,304.00	\$6.50	\$3,497.00	\$10.00	\$5,380.00	\$8.00	\$4,304.00				
47)	Sidewalk Ramp, Conc, 6 inch	143	Sft	\$10.00	\$1,430.00	\$8.50	\$1,215.50	\$13.00	\$1,859.00	\$10.00	\$1,430.00				
48)	Sign, Type IIIB	4	Sft	\$50.00	\$200.00	\$50.00	\$200.00	\$63.00	\$252.00	\$50.00	\$200.00				
49)	Turf Establishment	75	Syd	\$35.00	\$2,625.00	\$15.00	\$1,125.00	\$19.00	\$1,425.00	\$15.00	\$1,125.00				
TOTAL CATEGORY 3:				\$179,254.09 ²	TOTAL CATEGORY 3:				\$203,212.11	TOTAL CATEGORY 3:		\$211,576.00	TOTAL CATEGORY 3:		\$225,289.00
CATEGORY 4 - Cass															
50)	Audio Video Route Survey	1.00	LSUM	\$900.00	\$900.00	\$950.00	\$950.00	\$915.00	\$915.00	\$1,000.00	\$1,000.00				
51)	Mobilization, Max 5%	1.00	LSUM	\$5,000.00	\$5,000.00	\$4,783.00	\$4,783.00	\$1,000.00	\$1,000.00	\$5,000.00	\$5,000.00				
52)	Traffic Maintenance and Control	1.00	LSUM	\$1,050.00	\$1,050.00	\$3,500.00	\$3,500.00	\$1,500.00	\$1,500.00	\$10,000.00	\$10,000.00				
53)	Culv, Rem, Less than 24 inch	1.00	Ea	\$350.00	\$350.00	\$1,400.00	\$1,400.00	\$780.00	\$780.00 ⁴	\$1,400.00	\$1,400.00				
54)	Curb and Gutter, Rem	24.00	Ft	\$15.00	\$360.00	\$25.00	\$600.00	\$26.00	\$624.00	\$25.00	\$600.00				
55)	Pavt, Rem	51.00	Syd	\$25.00	\$1,275.00	\$22.00	\$1,122.00	\$28.00	\$1,428.00	\$22.00	\$1,122.00				
56)	Sidewalk, Rem	97.00	Syd	\$25.00	\$2,425.00	\$22.00	\$2,134.00	\$13.00	\$1,261.00	\$22.00	\$2,134.00				
57)	Sign, Remove & Reset	2.00	Ea	\$250.00	\$500.00	\$100.00	\$200.00	\$63.00	\$126.00	\$200.00	\$400.00				
58)	Erosion Control, Inlet Protection, Fabric Drop	4.00	Ea	\$105.00	\$420.00	\$245.00	\$980.00	\$260.00	\$1,040.00	\$250.00	\$1,000.00				
59)	Aggregate Base, 21AA (Limestone), 8 inch	25.00	Syd	\$12.00	\$300.00	\$20.00	\$500.00	\$30.00	\$750.00	\$50.00	\$1,250.00				
60)	Culv End Sect, 12 inch	11.00	Ea	\$150.00	\$1,650.00	\$1,100.00	\$12,100.00	\$1,200.00	\$13,200.00	\$1,100.00	\$12,100.00				
61)	Culv, CI IV, Conc, 12 inch	62.00	Ft	\$75.00	\$4,650.00	\$120.00	\$7,440.00	\$150.00	\$9,300.00	\$120.00	\$7,440.00				
62)	Cold Milling HMA Surface	2401.00	Syd	\$3.00	\$7,203.00	\$4.65	\$11,164.65	\$4.00	\$9,604.00	\$5.00	\$12,005.00				
63)	Hand Patching	6.00	Ton	\$250.00	\$1,500.00	\$500.00	\$3,000.00	\$700.00	\$4,200.00	\$500.00	\$3,000.00				

Tabulation of Bids Received on 4/13/2022
2022 Road Rehabilitation Program
 City of Farmington, Oakland County, MI
 OHM Job No.: 0111-21-0050

Best Asphalt, Inc.
 6334 N Beverly Plaza
 Romulus, MI 48174

Cadillac Asphalt
 13501 S Huron River Dr
 Romulus, MI 48174

Asphalt Specialists, Inc.
 1780 E Highwood
 Pontiac, MI 48340

Pro-Line Asphalt Paving Co.
 11797 29 Mile Rd
 Washington, MI 48095

Phone: (734) 729-9440

Phone: (734) 941-0200

Phone: (248) 334-4570

Phone: (586) 752-7730

Item No.	Description	Estimated Quantity	Best Asphalt, Inc.		Cadillac Asphalt		Asphalt Specialists, Inc.		Pro-Line Asphalt Paving Co.	
			Unit Price	Amount	Unit Price	Amount	Unit Price	Amount	Unit Price	Amount
64)	HMA, MDOT 13A	334.00 Ton	\$101.05	\$33,750.70	\$108.42	\$36,212.28	\$135.00	\$45,090.00	\$130.00	\$43,420.00
65)	Curb and Gutter, Conc, Det F4	55.00 Ft	\$50.00	\$2,750.00	\$55.00	\$3,025.00	\$63.00	\$3,465.00	\$50.00	\$2,750.00
66)	Detectable Warning Surface	40.00 Ft	\$60.00	\$2,400.00	\$40.00	\$1,600.00	\$75.00	\$3,000.00	\$60.00	\$2,400.00
67)	Sidewalk, Conc, 4 inch	592.00 Sft	\$8.00	\$4,736.00	\$6.50	\$3,848.00	\$10.00	\$5,920.00	\$8.00	\$4,736.00
68)	Sidewalk Ramp, Conc, 6 inch	586.00 Sft	\$10.00	\$5,860.00	\$8.50	\$4,981.00	\$13.00	\$7,618.00	\$10.00	\$5,860.00
69)	Turf Establishment	94.00 Syd	\$35.00	\$3,290.00	\$15.00	\$1,410.00	\$19.00	\$1,786.00	\$15.00	\$1,410.00
TOTAL CATEGORY 4:				<u>\$80,369.70</u>	<u>\$100,949.93</u>	<u>\$112,607.00</u> ⁵	<u>\$119,027.00</u>			

CATEGORY 5 - Hamlin Ct.

70)	Audio Video Route Survey	1 LSUM	\$850.00	\$850.00	\$775.00	\$775.00	\$913.00	\$913.00	\$1,000.00	\$1,000.00
71)	Mobilization, Max 5%	1 LSUM	\$2,800.00	\$2,800.00	\$2,747.00	\$2,747.00	\$1,000.00	\$1,000.00	\$3,000.00	\$3,000.00
72)	Traffic Maintenance and Control	1 LSUM	\$1,000.00	\$1,000.00	\$2,500.00	\$2,500.00	\$1,500.00	\$1,500.00	\$10,000.00	\$10,000.00
73)	Curb and Gutter, Rem	30 Ft	\$15.00	\$450.00	\$25.00	\$750.00	\$33.00	\$990.00	\$25.00	\$750.00
74)	Pavt, Rem	9 Syd	\$50.00	\$450.00	\$22.00	\$198.00	\$78.00	\$702.00	\$22.00	\$198.00
75)	Sidewalk, Rem	35 Syd	\$25.00	\$875.00	\$22.00	\$770.00	\$36.00	\$1,260.00	\$22.00	\$770.00
76)	Erosion Control, Inlet Protection, Fabric Drop	2 Ea	\$105.00	\$210.00	\$245.00	\$490.00	\$267.00	\$534.00	\$250.00	\$500.00
77)	Culv End Sect, 12 inch	1 Ea	\$150.00	\$150.00	\$1,100.00	\$1,100.00	\$1,600.00	\$1,600.00	\$1,100.00	\$1,100.00
78)	Cold Milling HMA Surface	2176 Syd	\$3.00	\$6,528.00	\$4.65	\$10,118.40	\$3.50	\$7,616.00	\$5.00	\$10,880.00
79)	Hand Patching	2 Ton	\$250.00	\$500.00	\$500.00	\$1,000.00	\$400.00	\$800.00	\$500.00	\$1,000.00
80)	HMA, MDOT 13A	300 Ton	\$101.05	\$30,315.00	\$108.42	\$32,526.00	\$135.00	\$40,500.00	\$130.00	\$39,000.00
81)	Curb and Gutter, Conc, Det F4	30 Ft	\$50.00	\$1,500.00	\$55.00	\$1,650.00	\$63.00	\$1,890.00	\$50.00	\$1,500.00
82)	Detectable Warning Surface	10 Ft	\$60.00	\$600.00	\$55.00	\$550.00	\$76.00	\$760.00	\$60.00	\$600.00
83)	Sidewalk, Conc, 4 inch	196 Sft	\$8.00	\$1,568.00	\$6.50	\$1,274.00	\$10.00	\$1,960.00	\$8.00	\$1,568.00
84)	Sidewalk Ramp, Conc, 6 inch	127 Sft	\$10.00	\$1,270.00	\$8.50	\$1,079.50	\$13.00	\$1,651.00	\$10.00	\$1,270.00
85)	Turf Establishment	45 Syd	\$35.00	\$1,575.00	\$15.00	\$675.00	\$19.00	\$855.00	\$15.00	\$675.00
TOTAL CATEGORY 5:				<u>\$50,641.00</u>	<u>\$58,202.90</u>	<u>\$64,531.00</u>	<u>\$73,811.00</u>			

CATEGORY 6 - Conroy Ct.

86)	Audio Video Route Survey	1.00 LSUM	\$850.00	\$850.00	\$775.00	\$775.00	\$913.00	\$913.00	\$1,000.00	\$1,000.00
87)	Mobilization, Max 5%	1.00 LSUM	\$3,000.00	\$3,000.00	\$3,095.00	\$3,095.00	\$1,000.00	\$1,000.00	\$3,000.00	\$3,000.00
88)	Traffic Maintenance and Control	1.00 LSUM	\$1,000.00	\$1,000.00	\$3,000.00	\$3,000.00	\$1,500.00	\$1,500.00	\$10,000.00	\$10,000.00
89)	Curb and Gutter, Rem	17.00 Ft	\$15.00	\$255.00	\$25.00	\$425.00	\$45.00	\$765.00	\$25.00	\$425.00
90)	Pavt, Rem	9.00 Syd	\$25.00	\$225.00	\$22.00	\$198.00	\$78.00	\$702.00	\$22.00	\$198.00
91)	Sidewalk, Rem	36.00 Syd	\$25.00	\$900.00	\$22.00	\$792.00	\$35.00	\$1,260.00	\$22.00	\$792.00
92)	Erosion Control, Inlet Protection, Fabric Drop	4.00 Ea	\$105.00	\$420.00	\$245.00	\$980.00	\$268.00	\$1,072.00	\$250.00	\$1,000.00
93)	Culv End Sect, 12 inch	2.00 Ea	\$150.00	\$300.00	\$1,100.00	\$2,200.00	\$1,350.00	\$2,700.00	\$1,100.00	\$2,200.00

Tabulation of Bids Received on 4/13/2022
2022 Road Rehabilitation Program
 City of Farmington, Oakland County, MI
 OHM Job No.: 0111-21-0050

Best Asphalt, Inc.
 6334 N Beverly Plaza
 Romulus, MI 48174

Cadillac Asphalt
 13501 S Huron River Dr
 Romulus, MI 48174

Asphalt Specialists, Inc.
 1780 E Highwood
 Pontiac, MI 48340

Pro-Line Asphalt Paving Co.
 11797 29 Mile Rd
 Washington, MI 48095

Phone: (734) 729-9440

Phone: (734) 941-0200

Phone: (248) 334-4570

Phone: (586) 752-7730

Item No.	Description	Estimated Quantity	Best Asphalt, Inc.		Cadillac Asphalt		Asphalt Specialists, Inc.		Pro-Line Asphalt Paving Co.	
			Unit Price	Amount	Unit Price	Amount	Unit Price	Amount	Unit Price	Amount
94)	Utility Structure, Adj	2.00 Ea	\$750.00	\$1,500.00	\$2,000.00	\$4,000.00	\$400.00	\$800.00	\$2,000.00	\$4,000.00
95)	Cold Milling HMA Surface	2218.00 Syd	\$3.00	\$6,654.00	\$4.65	\$10,313.70	\$3.50	\$7,763.00	\$5.00	\$11,090.00
96)	Hand Patching	2.00 Ton	\$250.00	\$500.00	\$500.00	\$1,000.00	\$400.00	\$800.00	\$500.00	\$1,000.00
97)	HMA, MDOT 13A	305.00 Ton	\$101.05	\$30,820.25	\$108.42	\$33,068.10	\$135.00	\$41,175.00	\$130.00	\$39,650.00
98)	Curb and Gutter, Conc, Det F4	30.00 Ft	\$50.00	\$1,500.00	\$55.00	\$1,650.00	\$63.00	\$1,890.00	\$50.00	\$1,500.00
99)	Detectable Warning Surface	10.00 Ft	\$60.00	\$600.00	\$40.00	\$400.00	\$76.00	\$760.00	\$60.00	\$600.00
100)	Sidewalk, Conc, 4 inch	258.00 Sft	\$8.00	\$2,064.00	\$6.50	\$1,677.00	\$10.00	\$2,580.00	\$8.00	\$2,064.00
101)	Sidewalk Ramp, Conc, 6 inch	136.00 Sft	\$10.00	\$1,360.00	\$8.50	\$1,156.00	\$13.00	\$1,768.00	\$10.00	\$1,360.00
102)	Turf Establishment	52.00 Syd	\$35.00	\$1,820.00	\$15.00	\$780.00	\$19.00	\$988.00	\$15.00	\$780.00
TOTAL CATEGORY 6:				<u>\$53,768.25</u>	<u>\$65,509.80</u>	<u>\$68,436.00</u>	<u>\$80,659.00</u>			

CATEGORY 7 - James Ct.

103)	Audio Video Route Survey	1.00 LSUM	\$950.00	\$950.00	\$775.00	\$775.00	\$900.00	\$900.00	\$1,000.00	\$1,000.00
104)	Mobilization, Max 5%	1.00 LSUM	\$3,250.00	\$3,250.00	\$3,110.00	\$3,110.00	\$1,000.00	\$1,000.00	\$3,000.00	\$3,000.00
105)	Traffic Maintenance and Control	1.00 LSUM	\$1,100.00	\$1,100.00	\$2,500.00	\$2,500.00	\$1,500.00	\$1,500.00	\$10,000.00	\$10,000.00
106)	Curb and Gutter, Rem	36.00 Ft	\$15.00	\$540.00	\$25.00	\$900.00	\$30.00	\$1,080.00	\$25.00	\$900.00
107)	Pavt, Rem	9.00 Syd	\$25.00	\$225.00	\$22.00	\$198.00	\$70.00	\$630.00	\$22.00	\$198.00
108)	Sidewalk, Rem	43.00 Syd	\$25.00	\$1,075.00	\$22.00	\$946.00	\$29.00	\$1,247.00	\$22.00	\$946.00
109)	Sign, Remove & Reset	1.00 Ea	\$150.00	\$150.00	\$100.00	\$100.00	\$63.00	\$63.00	\$200.00	\$200.00
110)	Erosion Control, Inlet Protection, Fabric Drop	2.00 Ea	\$105.00	\$210.00	\$245.00	\$490.00	\$267.00	\$534.00	\$250.00	\$500.00
111)	Cold Milling HMA Surface	2545.00 Syd	\$3.00	\$7,635.00	\$4.65	\$11,834.25	\$3.00	\$7,635.00	\$5.00	\$12,725.00
112)	Hand Patching	2.00 Ton	\$250.00	\$500.00	\$500.00	\$1,000.00	\$400.00	\$800.00	\$500.00	\$1,000.00
113)	HMA, MDOT 13A	350.00 Ton	\$101.05	\$35,367.50	\$108.42	\$37,947.00	\$135.00	\$47,250.00	\$130.00	\$45,500.00
114)	Curb and Gutter, Conc, Det F4	36.00 Ft	\$50.00	\$1,800.00	\$55.00	\$1,980.00	\$63.00	\$2,268.00	\$50.00	\$1,800.00
115)	Detectable Warning Surface	10.00 Ft	\$60.00	\$600.00	\$40.00	\$400.00	\$76.00	\$760.00	\$60.00	\$600.00
116)	Sidewalk, Conc, 4 inch	252.00 Sft	\$8.00	\$2,016.00	\$6.50	\$1,638.00	\$10.00	\$2,520.00	\$8.00	\$2,016.00
117)	Sidewalk Ramp, Conc, 6 inch	139.00 Sft	\$10.00	\$1,390.00	\$8.50	\$1,181.50	\$13.00	\$1,807.00	\$10.00	\$1,390.00
118)	Turf Establishment	56.00 Syd	\$35.00	\$1,960.00	\$15.00	\$840.00	\$19.00	\$1,064.00	\$15.00	\$840.00
TOTAL CATEGORY 7:				<u>\$58,768.50</u>	<u>\$65,839.75</u>	<u>\$71,058.00</u>	<u>\$82,615.00</u>			

CATEGORY 8 - Moore St.

119)	Audio Video Route Survey	1.00 LSUM	\$1,250.00	\$1,250.00	\$875.00	\$875.00	\$913.00	\$913.00	\$1,000.00	\$1,000.00
120)	Mobilization, Max 5%	1.00 LSUM	\$4,050.00	\$4,050.00	\$4,300.00	\$4,300.00	\$1,000.00	\$1,000.00	\$5,000.00	\$5,000.00
121)	Traffic Maintenance and Control	1.00 LSUM	\$1,425.00	\$1,425.00	\$8,500.00	\$8,500.00	\$1,500.00	\$1,500.00	\$10,000.00	\$10,000.00
122)	Culv, Rem, Less than 24 inch	1.00 Ea	\$350.00	\$350.00	\$1,400.00	\$1,400.00	\$450.00	\$450.00	\$1,400.00	\$1,400.00
123)	Curb and Gutter, Rem	7.00 Ft	\$50.00	\$350.00	\$25.00	\$175.00	\$86.00	\$602.00	\$25.00	\$175.00

Tabulation of Bids Received on 4/13/2022
2022 Road Rehabilitation Program
 City of Farmington, Oakland County, MI
 OHM Job No.: 0111-21-0050

Best Asphalt, Inc.
 6334 N Beverly Plaza
 Romulus, MI 48174

Cadillac Asphalt
 13501 S Huron River Dr
 Romulus, MI 48174

Asphalt Specialists, Inc.
 1780 E Highwood
 Pontiac, MI 48340

Pro-Line Asphalt Paving Co.
 11797 29 Mile Rd
 Washington, MI 48095

Item No.	Description	Estimated Quantity	Best Asphalt, Inc.		Cadillac Asphalt		Asphalt Specialists, Inc.		Pro-Line Asphalt Paving Co.	
			Unit Price	Amount	Unit Price	Amount	Unit Price	Amount	Unit Price	Amount
124)	Pavt, Rem	27.00 Syd	\$25.00	\$675.00	\$22.00	\$594.00	\$54.00	\$1,458.00	\$22.00	\$594.00
125)	Sidewalk, Rem	38.00 Syd	\$25.00	\$950.00	\$22.00	\$836.00	\$33.00	\$1,254.00	\$22.00	\$836.00
126)	Sign, Remove & Reset	1.00 Ea	\$250.00	\$250.00	\$100.00	\$100.00	\$63.00	\$63.00	\$200.00	\$200.00
127)	Erosion Control, Inlet Protection, Fabric Drop	4.00 Ea	\$105.00	\$420.00	\$245.00	\$980.00	\$267.00	\$1,068.00	\$250.00	\$1,000.00
128)	Aggregate Base, 21AA (Limestone), 8 inch	19.00 Syd	\$12.00	\$228.00	\$20.00	\$380.00	\$32.00	\$608.00	\$50.00	\$950.00
129)	Culv End Sect, 12 inch	1.00 Ea	\$150.00	\$150.00	\$1,100.00	\$1,100.00	\$1,000.00	\$1,000.00	\$1,100.00	\$1,100.00
130)	Culv, CI IV, Conc, 12 inch	46.00 Ft	\$75.00	\$3,450.00	\$120.00	\$5,520.00	\$162.00	\$7,452.00	\$120.00	\$5,520.00
131)	Culv End Sect, 8 inch	1.00 Ea	\$125.00	\$125.00	\$690.00	\$690.00	\$1,420.00	\$1,420.00	\$690.00	\$690.00
132)	Dr Structure, Tap, 12 inch	1.00 Ea	\$150.00	\$150.00	\$1,100.00	\$1,100.00	\$315.00	\$315.00	\$1,100.00	\$1,100.00
133)	Cold Milling HMA Surface	3292.00 Syd	\$3.00	\$9,876.00	\$4.45	\$14,649.40	\$3.50	\$11,522.00	\$5.00	\$16,460.00
134)	Hand Patching	2.00 Ton	\$250.00	\$500.00	\$500.00	\$1,000.00	\$400.00	\$800.00	\$500.00	\$1,000.00
135)	HMA, MDOT 13A	457.00 Ton	\$101.05	\$46,179.85	\$108.42	\$49,547.94	\$135.00	\$61,695.00	\$130.00	\$59,410.00
136)	Curb and Gutter, Conc, Det F4	24.00 Ft	\$50.00	\$1,200.00	\$55.00	\$1,320.00	\$63.00	\$1,512.00	\$50.00	\$1,200.00
137)	Detectable Warning Surface	10.00 Ft	\$60.00	\$600.00	\$40.00	\$400.00	\$76.00	\$760.00	\$60.00	\$600.00
138)	Sidewalk, Conc, 4 inch	172.00 Sft	\$8.00	\$1,376.00	\$6.50	\$1,118.00	\$10.00	\$1,720.00	\$8.00	\$1,376.00
139)	Sidewalk Ramp, Conc, 6 inch	147.00 Sft	\$10.00	\$1,470.00	\$8.50	\$1,249.50	\$13.00	\$1,911.00	\$10.00	\$1,470.00
140)	Turf Establishment	33.00 Syd	\$25.00	\$825.00	\$15.00	\$495.00	\$19.00	\$627.00	\$15.00	\$495.00
TOTAL CATEGORY 8:				\$75,849.85	\$96,329.84	\$99,650.00	\$111,576.00			

CATEGORY 9 - Fleming St.										
141)	Audio Video Route Survey	1.00 LSUM	\$1,600.00	\$1,600.00	\$950.00	\$950.00	\$1,000.00	\$1,000.00	\$1,000.00	\$1,000.00
142)	Mobilization, Max 5%	1.00 LSUM	\$7,700.00	\$7,700.00	\$8,040.00	\$8,040.00	\$1,000.00	\$1,000.00	\$8,000.00	\$8,000.00
143)	Traffic Maintenance and Control	1.00 LSUM	\$1,800.00	\$1,800.00	\$6,250.00	\$6,250.00	\$1,500.00	\$1,500.00	\$10,000.00	\$10,000.00
144)	Culv, Rem, Less than 24 inch	3.00 Ea	\$350.00	\$1,050.00	\$1,400.00	\$4,200.00	\$470.00	\$1,410.00	\$1,400.00	\$4,200.00
145)	Dr Structure, Rem	1.00 Ea	\$500.00	\$500.00	\$1,340.00	\$1,340.00	\$2,000.00	\$2,000.00 ⁴	\$1,340.00	\$1,340.00
146)	Curb and Gutter, Rem	9.00 Ft	\$50.00	\$450.00	\$25.00	\$225.00	\$58.00	\$522.00 ⁴	\$25.00	\$225.00
147)	Pavt, Rem	80.00 Syd	\$25.00	\$2,000.00	\$22.00	\$1,760.00	\$29.00	\$2,320.00	\$22.00	\$1,760.00
148)	Sidewalk, Rem	18.00 Syd	\$25.00	\$450.00	\$22.00	\$396.00	\$70.00	\$1,260.00	\$22.00	\$396.00
149)	Sign, Rem	2.00 Ea	\$150.00	\$300.00	\$50.00	\$100.00	\$63.00	\$126.00	\$200.00	\$400.00
150)	Ditch Cleanout, Special	1622.00 Ft	\$15.00	\$24,330.00	\$10.00	\$16,220.00	\$7.00	\$11,354.00	\$10.00	\$16,220.00
151)	Erosion Control, Inlet Protection, Fabric Drop	4.00 Ea	\$105.00	\$420.00	\$245.00	\$980.00	\$267.00	\$1,068.00	\$250.00	\$1,000.00
152)	Aggregate Base, 21AA (Limestone), 8 inch	20.00 Syd	\$35.00	\$700.00	\$20.00	\$400.00	\$31.00	\$620.00	\$20.00	\$400.00
153)	Aggregate Base, 21AA (Limestone), Drive Approach, 6 inch	62.00 Syd	\$30.00	\$1,860.00	\$11.00	\$682.00	\$31.00	\$1,922.00	\$11.00	\$682.00
154)	Culv End Sect, 12 inch	7.00 Ea	\$150.00	\$1,050.00	\$1,100.00	\$7,700.00	\$1,300.00	\$9,100.00	\$1,100.00	\$7,700.00
155)	Culv, CI IV, Conc, 12 inch	95.00 Ft	\$75.00	\$7,125.00	\$120.00	\$11,400.00	\$200.00	\$19,000.00	\$120.00	\$11,400.00
156)	Dr Structure, 48 inch dia	1.00 Ea	\$2,750.00	\$2,750.00	\$3,500.00	\$3,500.00	\$5,000.00	\$5,000.00	\$3,500.00	\$3,500.00
157)	Cold Milling HMA Surface	4324.00 Syd	\$2.75	\$11,891.00	\$4.34	\$18,766.16	\$3.50	\$15,134.00	\$5.00	\$21,620.00

Tabulation of Bids Received on 4/13/2022
2022 Road Rehabilitation Program
 City of Farmington, Oakland County, MI
 OHM Job No.: 0111-21-0050

Best Asphalt, Inc.
 6334 N Beverly Plaza
 Romulus, MI 48174

Cadillac Asphalt
 13501 S Huron River Dr
 Romulus, MI 48174

Asphalt Specialists, Inc.
 1780 E Highwood
 Pontiac, MI 48340

Pro-Line Asphalt Paving Co.
 11797 29 Mile Rd
 Washington, MI 48095

Item No.	Description	Estimated Quantity	Best Asphalt, Inc.		Cadillac Asphalt		Asphalt Specialists, Inc.		Pro-Line Asphalt Paving Co.	
			Unit Price	Amount	Unit Price	Amount	Unit Price	Amount	Unit Price	Amount
158)	Hand Patching	1.00 Ton	\$250.00	\$250.00	\$500.00	\$500.00	\$700.00	\$700.00	\$500.00	\$500.00
159)	HMA, MDOT 13A	598.00 Ton	\$101.05	\$60,427.90	\$108.42	\$64,835.16	\$135.00	\$80,730.00	\$130.00	\$77,740.00
160)	Driveway, Nonreinf Conc, 6 inch	31.00 Syd	\$70.00	\$2,170.00	\$67.50	\$2,092.50	\$89.00	\$2,759.00	\$70.00	\$2,170.00
161)	Curb and Gutter, Conc, Det F4	9.00 Ft	\$50.00	\$450.00	\$55.00	\$495.00	\$63.00	\$567.00	\$50.00	\$450.00
162)	Detectable Warning Surface	6.00 Ft	\$60.00	\$360.00	\$40.00	\$240.00	\$76.00	\$456.00	\$60.00	\$360.00
163)	Sidewalk, Conc, 4 inch	93.00 Sft	\$8.00	\$744.00 ¹	\$6.50	\$604.50	\$10.00	\$930.00	\$8.00	\$744.00
164)	Sidewalk, Conc, 6 inch	90.00 Sft	\$10.00	\$900.00	\$8.50	\$765.00	\$13.00	\$1,170.00	\$10.00	\$900.00
165)	Post, Steel, 3 lb	14.00 Ft	\$15.00	\$210.00	\$15.00	\$210.00	\$19.00	\$266.00	\$25.00	\$350.00
166)	Sign, Type IIIB	5.00 Sft	\$50.00	\$250.00	\$50.00	\$250.00	\$63.00	\$315.00	\$50.00	\$250.00
167)	Turf Establishment	2271.00 Syd	\$10.00	\$22,710.00	\$7.50	\$17,032.50	\$10.00	\$22,710.00	\$10.00	\$22,710.00
TOTAL CATEGORY 9:				<u>\$154,447.90</u> ²	<u>\$169,933.82</u>	<u>\$184,939.00</u> ⁵	<u>\$196,017.00</u>			

CATEGORY 10 - Alta Loma Dr.										
Item No.	Description	Estimated Quantity	Best Asphalt, Inc.		Cadillac Asphalt		Asphalt Specialists, Inc.		Pro-Line Asphalt Paving Co.	
			Unit Price	Amount	Unit Price	Amount	Unit Price	Amount	Unit Price	Amount
168)	Audio Video Route Survey	1.00 LSUM	\$1,850.00	\$1,850.00	\$1,050.00	\$1,050.00	\$910.00	\$910.00	\$1,000.00	\$1,000.00
169)	Mobilization, Max 5%	1.00 LSUM	\$7,250.00	\$7,250.00	\$6,185.00	\$6,185.00	\$1,000.00	\$1,000.00	\$7,000.00	\$7,000.00
170)	Traffic Maintenance and Control	1.00 LSUM	\$2,100.00	\$2,100.00	\$5,000.00	\$5,000.00	\$1,500.00	\$1,500.00	\$10,000.00	\$10,000.00
171)	Curb and Gutter, Rem	54.00 Ft	\$25.00	\$1,350.00	\$25.00	\$1,350.00	\$22.00	\$1,188.00	\$25.00	\$1,350.00
172)	Pavt, Rem	22.00 Syd	\$50.00	\$1,100.00	\$22.00	\$484.00	\$60.00	\$1,320.00	\$22.00	\$484.00
173)	Sidewalk, Rem	149.00 Syd	\$25.00	\$3,725.00	\$22.00	\$3,278.00	\$13.00	\$1,937.00	\$22.00	\$3,278.00
174)	Sign, Remove & Reset	1.00 Ea	\$350.00	\$350.00	\$100.00	\$100.00	\$63.00	\$63.00	\$200.00	\$200.00
175)	Erosion Control, Inlet Protection, Fabric Drop	10.00 Ea	\$105.00	\$1,050.00	\$245.00	\$2,450.00	\$267.00	\$2,670.00	\$250.00	\$2,500.00
176)	Cold Milling HMA Surface	4735.00 Syd	\$2.75	\$13,021.25	\$4.34	\$20,549.90	\$4.00	\$18,940.00	\$5.00	\$23,675.00
177)	Hand Patching	5.00 Ton	\$250.00	\$1,250.00	\$500.00	\$2,500.00	\$460.00	\$2,300.00	\$500.00	\$2,500.00
178)	HMA, MDOT 13A	651.00 Ton	\$101.05	\$65,783.55	\$108.42	\$70,581.42	\$135.00	\$87,885.00	\$120.00	\$78,120.00
179)	Conc Pavt with Integral Curb, Nonreinf, 8 inch	6.00 Syd	\$70.00	\$420.00	\$82.25	\$493.50	\$100.00	\$600.00	\$80.00	\$480.00
180)	Curb and Gutter, Conc, Det F4	54.00 Ft	\$50.00	\$2,700.00	\$55.00	\$2,970.00	\$63.00	\$3,402.00	\$50.00	\$2,700.00
181)	Detectable Warning Surface	33.00 Ft	\$60.00	\$1,980.00	\$40.00	\$1,320.00	\$75.00	\$2,475.00	\$60.00	\$1,980.00
182)	Sidewalk, Conc, 4 inch	745.00 Sft	\$8.00	\$5,960.00	\$6.50	\$4,842.50	\$10.00	\$7,450.00	\$8.00	\$5,960.00
183)	Sidewalk Ramp, Conc, 6 inch	721.00 Sft	\$10.00	\$7,210.00	\$8.50	\$6,128.50	\$13.00	\$9,373.00	\$10.00	\$7,210.00
184)	Turf Establishment	177.00 Syd	\$15.00	\$2,655.00	\$15.00	\$2,655.00	\$19.00	\$3,363.00	\$15.00	\$2,655.00
TOTAL CATEGORY 10:				<u>\$119,754.80</u>	<u>\$131,937.82</u>	<u>\$146,376.00</u>	<u>\$151,092.00</u>			

TOTAL BID AMOUNT: \$953,316.54 ³ \$1,058,678.94 \$1,122,874.50 ⁶ \$1,227,032.00

Tabulation of Bids Received on 4/13/2022
2022 Road Rehabilitation Program
 City of Farmington, Oakland County, MI
 OHM Job No.: 0111-21-0050

Best Asphalt, Inc.
 6334 N Beverly Plaza
 Romulus, MI 48174

Cadillac Asphalt
 13501 S Huron River Dr
 Romulus, MI 48174

Asphalt Specialists, Inc.
 1780 E Highwood
 Pontiac, MI 48340

Pro-Line Asphalt Paving Co.
 11797 29 Mile Rd
 Washington, MI 48095

Phone: (734) 729-9440

Phone: (734) 941-0200

Phone: (248) 334-4570

Phone: (586) 752-7730

<u>Item No.</u>	<u>Description</u>	<u>Estimated Quantity</u>	<u>Unit Price</u>	<u>Amount</u>	<u>Unit Price</u>	<u>Amount</u>	<u>Unit Price</u>	<u>Amount</u>	<u>Unit Price</u>	<u>Amount</u>
-----------------	--------------------	---------------------------	-------------------	---------------	-------------------	---------------	-------------------	---------------	-------------------	---------------

CORRECTIONS

- ¹ Amount adjusted to reflect bidder's multiplication error
- ² Total adjusted to reflect bidder's above error
- ³ Bid total adjusted to reflect bidder's above errors
- ⁴ Amount adjusted to reflect bidder's multiplication error
- ⁵ Total adjusted to reflect bidder's above error
- ⁶ Bid total adjusted to reflect bidder's above errors

**Farmington City Council
Agenda Item**

**Council Meeting
Date: May 2, 2022**

**Item Number
10**

Submitted by: City Manager David Murphy

Agenda Topic: Temporary Construction Easement for Paving Repairs on Sunny Day Care Public Access Easement Area

Proposed Motion: Approve the Sunny Day Care Temporary Construction Easement authorizing Paving Repairs within the existing public access easement area

Background: Sunny Day Care granted the City the existing public access easement in 1999 for public use of the paved parking area for through traffic between Slocum and Orchard Street at the time the City approved Sunny Day Care’s Special Land Use approval for its daycare located at 33200 Slocum. The public access easement provides rights for the public to drive through the parking lot but not park and use the parking spaces. Over the years the use of the public access area has increased. In order to bring the parking lot up to City standards for continued public access, the City has requested, and Sunny Day Care has granted a Temporary Construction Easement to authorize the paving repairs since the existing public access Easement does not contain any authorizations to use the property for more than ingress and egress.

The agreement is MDOT’s standard form for a Cost Participation Agreement for a federally funded project and has been reviewed by the City Attorney’s office.

Materials Attached: Existing public access Easement and Proposed Temporary Construction Easement.

TEMPORARY CONSTRUCTION (GRADING) EASEMENT AGREEMENT

THIS TEMPORARY CONSTRUCTION (GRADING) EASEMENT AGREEMENT (“Agreement”) is made and entered into this ____ day of _____, 2022 between **SUNNY DAY CARE, INC.**, a Michigan Corporation whose address is 33200 SLOCUM, FARMINGTON, MI 48336 (hereinafter referred to as “Grantor”), and the **CITY OF FARMINGTON**, a Michigan Municipal Corporation, whose address is 23600 Liberty Street, Farmington, MI, 48335 Michigan 48375, (hereinafter referred to as “Grantee”).

RECITALS

A. Grantor is the owner of certain real property located on Farmington Road, Sidwell No. 50-23-27-301-047, as shown on **Exhibit A**, which is attached hereto and made a part hereof (hereinafter referred to as “Grantor’s Property”); and

B. Grantee desires to temporarily acquire from Grantor certain rights to access Grantor’s Property, to move men and equipment on and through, remove noxious vegetation, grade, and install/repair paving improvements on , in, over, upon and through the portion of Grantor’s Property described in the attached and incorporated **Exhibit A (hereinafter the “Easement Premises”)**, in accordance with the Construction Plans for Grantee’s Streetscape Improvement Project, attached hereto and incorporated as **Exhibit B (the “Construction Plans”)**.

IT IS THEREFORE AGREED:

1. **Grant of Easement.** In consideration of the sum of One Dollar (\$1.00), and other valuable consideration, Grantor hereby grants to Grantee a temporary, non-exclusive construction easement (the “Easement”) as described in **Exhibit A**.

2. **Character of Easement.** The Easement granted herein is personal to Grantee and its agents, contractors and assigns for the purpose of completing the repaving and repair of the parking lot and driveway;

3. **Purpose of Easement.** The Easement herein shall be used only for the purpose of grading, the movement of personnel and equipment, the removal of noxious trees and vegetation, and the installation and/or repair of paving in connection with the construction of Grantee’s Construction Plans, as set forth in the attached and incorporated **Exhibit B**.

4. **Location and Description of Easement.** The location of the Easement Premises is shown in the plan marked as **Exhibit A**;

5. **Construction and Installation.** The construction and installation of the paving and repairs shall be completed at the sole cost and expense of Grantee. During all aspects of any work performed on the Easement Premises, Grantee also covenants and agrees to do the following:

a. Immediately backfill and temporarily restore, on a daily basis, all driveways, parking lots and sidewalk areas located upon the Easement Premises and disturbed by virtue of the use of the Easement Premises, if any, until such time as final restoration of the affected areas occur pursuant to Paragraph 6 herein;

- b. Immediately backfill or fence during working hours all excavations on Grantor's Property or the Easement Premises when not supervised to ensure safety;
- c. Provide Grantor with continued access to the Easement Premises; and

6. Restoration. If upon complete installation and construction of the improvements, the Grantor's Property has been affected in any manner by said installation and construction, Grantee shall, at its sole cost and expense, restore Grantor's Property to a condition as good as its condition prior to such work.

7. Insurance. Grantee shall require each contractor performing work on the Easement Premises to keep in force at its sole cost and expense during and until completion of any construction and installation or any such work performed upon the Premises, in a form acceptable to Grantor, an Owner's and Contractor's Protective Policy naming Grantor as the principal insured and shall also require each contractor to name Grantor as an additional insured on all Contractor Policies of insurance with both policies having minimum limits of \$1,000,000.00 on account of bodily injuries to or death of one person, and minimum limits of \$2,000,000.00 on account of bodily injuries or death of more than one person, or such other amounts as Grantor may, from time to time, reasonably request, as a result of any one accident or occurrence; and property damage insurance with minimum limits of \$1,000,000.00, or such other amounts as Grantor may, from time to time, reasonably request. Prior to commencement of any work, Grantee shall provide Grantor with a certificate of insurance or other written evidence of Grantor's coverage as an additional insured, including an endorsement which states that such insurance may not be cancelled except upon ten (10) days prior written notice to Grantor.

8. Covenants to Run with Land. The covenants contained in this Agreement shall run with the land and shall be binding upon the parties and their respective heirs, representatives and successors.

9. Expiration. The above-described Temporary Construction (Grading) Easement Agreement shall become null and void upon the completion and final inspection of the Streetscape Improvement Project or October 31, 2023, whichever is earlier.

10. Liens. Grantee shall not permit any construction liens to be filed against its or Grantor's interest under this Temporary Construction (Grading) Easement or any interest it or Grantor holds in the Easement Premises. If any such construction liens shall attach, Grantee shall bond it off or otherwise cause it to be discharged within thirty (30) days from the date of its filing.

11. Indemnification. *To the extent permitted by applicable law,* Grantee for itself and its successors and assigns agrees to indemnify and defend Grantor against all claims, suits, liability, and expense on account of injury or death of persons or damage to property caused by or arising out of any negligent or otherwise wrongful acts or omissions of Grantee or any licensee, contractor, agent, or invitee of Grantee in connection with this Easement, and not caused or contributed to by the willful misconduct of Grantor.

12. Entire Agreement. This Agreement contains the entire agreement between the parties relating to the rights herein granted and the obligations herein assumed. Any oral representations or modifications concerning this Agreement shall be of no force and effect. Any modification of this Agreement must be in writing and must be signed by the party to be charged.

IN WITNESS WHEREOF, the parties hereto have executed this Temporary Construction (Grading) Easement Agreement as of the day and year first above written.

{Signatures Begin on Following Page}

GRANTEE:

CITY OF FARMINGTON

By: _____
Sara Bowman,
Its: Mayor

By: _____
Mary Mullison,
Its: Clerk

STATE OF MICHIGAN)
) ss
COUNTY OF _____)

On this ____ day of _____, 2021, before me personally appeared Sara Bowman, Mayor, and Mary Mullison, Clerk of the City of Farmington, a Michigan municipal corporation, to me known to be the same person who executed the within instrument on its behalf and who acknowledges the same to be the free act and deed.

_____, Notary Public
County, Michigan
My commission expires:

Part of Sidwell No. 23-27-301-047

Recording Fee: _____

Drafted by:

Elizabeth Saarela
Rosati, Schultz, Joppich & Amtsbeuchler
27555 Executive Drive, Suite 250
Farmington Hills, MI 48331

When recorded return to:

Mary Mullison, City Clerk
City of Farmington
23600 Liberty St
Farmington, MI 48335

EXHIBIT A

The paved parking/driving surface of Parcel 50-23-27-301-047, which parcel is described as:

LEGAL DESCRIPTION OF PROPERTY/EASEMENT AREAT1N, R9E, SEC 27 PART OF SW 1/4 BEG AT PT DIST N 2250.11 FT & E 294.57 FT & S 78-17-50 E 71.55 FT & N 140 FT FROM SW SEC COR, TH E 148.50 FT, TH N 00-02-00 W 112.59 FT, TH N 89-24-00 W 147.64 FT, TH S 111.62 FT TO BEG, ALSO PART OF SW 1/4 BEG AT PT DIST N 2220.75 FT & E 514.47 FT FROM SW SEC COR, TH N 00-33-30 W 154.51 FT, TH W 148.50 FT, TH S 140 FT, TH S 78-17-50 E 71.52 FT, TH E 79.47 FT TO BEG 0.90 A5-25-99 FR 023 & 043

EXHIBIT B
GRANTEE'S CONSTRUCTION PLANS

Farmington City Council Staff Report	Council Meeting Date: May 2, 2022	Item Number 11
Submitted by: Assistant to the City Manager Melissa Andrade		
Agenda Topic: Appointment to Commission on Children, Youth and Families		
Proposed Motion: Move to appoint _____ to a regular seat on the Commission for Children Youth and Families, and _____ as an alternate on the same commission. Both terms are through December 31, 2024.		
Background: City Council interviewed Jordan Scrimger for the vacancy on the Children Youth and Families at its April 18, 2022 meeting. Jordan had previously served on this commission as a Farmington Hills representative but has moved to the City of Farmington and would like to continue her service on this board. City Council interviewed Colleen Coogan at its March 21, 2022 meeting. She is also interested in this commission.		
Materials:		

Farmington City Council Staff Report	Council Meeting Date: May 2, 2022	Item Number 12
Submitted by: Assistant to the City Manager Melissa Andrade		
Agenda Topic: Board and Commission Interview: Kevin Parkins for Historical Commission		
Proposed Motion: Move to appoint Kevin Parkins to the Farmington Historical Commission for 3-year term through March 31, 2025.		
<p>Background: At its April 18 Special City Council Meeting, Council interviewed Kevin Parkins for the vacancy on the Farmington Historical Commission. Included in that council packet was a letter of recommendation from David Walsh.</p> <p>The Historical Commission meeting is the fourth Thursday of the month at 7 p.m.</p> <p>The Historical Commission was established by the City of Farmington in 1973 1) to safeguard the heritage of the City by preserving the cultural, social, economic, political and architectural elements having historic significance; 2) to stabilize and improve property values in such districts; 3) to foster and promote civic beautification with emphasis on historical significance; 4) to promote the use of local history for education, pleasure and the welfare of the citizens of the City; and 5) to encourage the collection of records and objects which interpret the history of Farmington, and cooperate in the establishment and operation of a museum or other appropriate center for custody and display of such items.</p>		
Materials:		